



## Motor & Solenoid Driven Electronic Safe Locks



**2004 200**

**6120 & 6123**

Mfg #	Users	EZ #
2004 200	5	086872
6120 305	9	025767
6120 329	9	077190
6123 303	7	066391

- Underwriters Laboratories Listed Type 1
- The Z02 D-Drive lock features a counterbalanced solenoid locking mechanism for a high level of security and extended battery life.
- The D-Drive keypad features a sure-grip, low profile design, with external battery placement for easy changing.
- Manual bolt operation—bolt retraction and extension is accomplished by turning the outer ring of the keypad after a valid code is entered.
- No-twist cable design virtually eliminates cable damage due to keypad rotation. Cable is fully protected inside a special spindle channel.
- Management reset code, one master code, one supervisor code, five user codes, and one time delay override code.
- Management reset code (MRC) restores the lock to its original factory code if the master code is lost.
- Time delay up to ninety-nine minutes, and three modes of operation (single control, dual control, and manager/employee mode).
- The Z02 D-Drive lock incorporates a penalty time feature to prevent opening by entering sequential or random codes until a valid code is found.

- All programming is quickly and easily done via the keypad (no separate programming equipment required).
- The lock bolt model withstands 225 lbs. of bolt end pressure for superior security in boltwork blocking applications.

### 6120 305

- 2 9-volt alkaline battery model allows for over 8,000 openings between battery changes.
- Low battery indicator signals by twenty consecutive beeps that will be heard after the last number of the code and the # sign have been pressed.
- Retrofits existing R6730 look footprint.
- Underwriters Laboratories Listed Type 1.
- A motor-driven lock bolt offers a high level of security by eliminating the threat of vibration and bouncing attacks.
- Codes consist of 6 digits giving a possible 1,000,000 codes.
- Management reset code, one master code, and eight user codes.
- Management reset code (MRC) restores the lock to its original factory code if the master code is lost.
- Time delay up to 9 minutes.

- Incorporates a penalty time feature to prevent opening by entering sequential or random codes until a valid code is found. Unit will lock out for 5 minutes.
- All programming is quickly and easily done via the keypad (no separate programming equipment required).
- The deadlocking square bolt withstands 225 lbs. of bolt end pressure for a high level of security and durability in boltwork blocking applications.

### 6120 329

- All the same features as the 6120 305 but one battery model allows battery to be changed externally. Battery needs to be changed more frequently than 2 battery version

### 6123 303

- All of the features of 6120 305 lock but with the following enhancements:
- Management reset code, one master code, one supervisor code, five user codes, and one time delay override code.
- Time delay up to ninety-nine minutes, and three modes of operation (single control, dual control, and manager/employee mode).

## 6730 Series Group 2 Combination Safe Locks

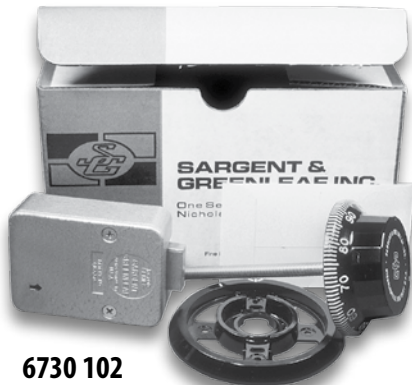

**6730 102**

- U.L. Group 2 rating.
- Brass & Aluminum Wheel Centers
- Internal relock trigger secures the lock in the event of a burglar's punch attack.
- Combinations: 1 Million - 3 Wheel (6730) & 100 Million - 4 Wheel (6731)
- Includes a torque adjustment feature for dialing tension.
- 4-way drive cam for mounting right-hand, left-hand, vertical-up, or vertical-down.
- Spyproof version includes D220 Dial & R162 Ring
- Front Reading version includes D003 Dial & R004 Ring

Mfg #	Type	Wheels	EZ #
6731 004	Lock Only	4	037028
6730 010	Lock Only	3	027437
6730 101	Front Reading Kit	3	037025
6730 102	Spy Proof Kit	3	037026

## 8550 Group 1 Manipulation Proof Safe Lock

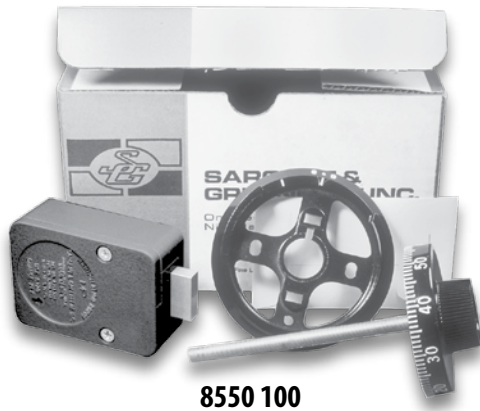

8550 100

- 8550 Series: Underwriters Laboratories Listed Group 1 Lock with Spy Proof Dial & Ring.
- Three wheels (made of brass and aluminum or acetal resin) provide 1,000,000 theoretical combinations.
- Manipulation resistance tested and verified by Underwriters Laboratories to exceed 20 man-hours.
- The 8560 Series has also been tested against 20 man-hours of radiological imaging attacks by Underwriters Laboratories.
- Internal relock trigger secures the lock in the event of a burglar's punch attack.
- Mount right-hand, left-hand, vertical-up, or vertical-down.

Mfg #	EZ #
8550 100	028749

## 6530 Group 1 Vault Locks

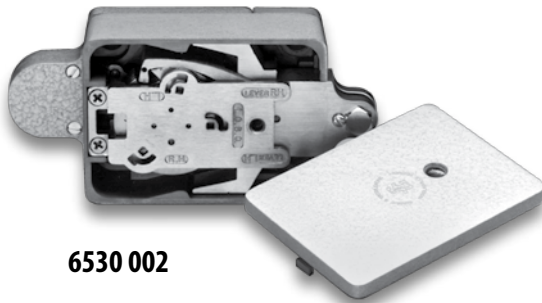

6530 002

- Underwriters Laboratories Listed Group 1
- Extra heavy duty construction for long life and exceptional durability in vault applications.
- Four brass and aluminum combination wheels provide 100,000,000 theoretical combinations.
- Ultra-dependable gravity activated lever allows the lock to be mounted right-hand or left-hand.
- Not for vertical-up or vertical down applications.
- Supplied with Roller Bolt

Mfg #	EZ #
6530 002	037020

## Double Horn Safe Deposit Locks

- Listed by Underwriters Laboratories under Standard 437.
- The pick resistant lever design resists advanced decoding techniques.
- Key retained.
- Two renter keys are provided with each lock. Renter sides are keyed different. Prep keys are not provided.
- Brass plated covers and plugs.
- Nose Diameter: .672
- Nose Height: .500

Mfg #	Hand	Prep Guard	EZ #
4420 010	LH	#4	037010
4420 042	RH	#4	037011
4440 018	LH	#4	013202
4440 032	LH	#89	037013
4440 070	RH	#4	013203
4440 088	RH	#89	037014



4420

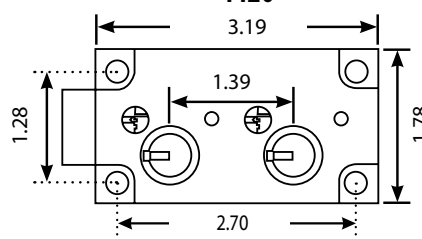

4440

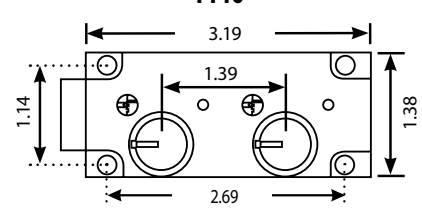



## Safe Lock Dial & Rings



**D003 with R004**



**D022/D023 with R162**

Dials			Rings		Finish	For Series
Mfg #	Description	EZ #	Mfg #	EZ #		
D003 003	3" Standard Front Reading	027424	R004 002	013183	B/W	Group 2
D017 007	2-7/16" Standard Front Reading	036985	R034 002	036988	B/W	Group 2
D022 013	Old Standard Spy Proof	036986	Not Stocked		OSN	Group 2
D022 028	Old Standard Spy Proof	027426	R162 002	027427	B/W	Group 2
D023 001	Old Standard Spy Proof	036987	R162 002	027427	B/W	6500
D220 014	New Standard Spy Proof	028156	R167 002	027726	B/W	Group 2
D225 024	New Standard Spy Proof with Key Locking	027440	R167 002	027726	B/W	Group 2
D300 018	Large Knob Front Reading	027718	R211 002	013182	B/W	Group 2
D690 009	Large Knob Front Reading with Key Locking	013187	R211 002	013182	B/W	Group 2

**B/W: Black & White, OSN: Silver Nickle**



**D220 with R167**



**D225 with R167**



**D300 with R211**



**D690 with R211**

- Dials and rings are sold separately.
- Spyproof: Spyproof dials and rings provide added security by permitting only the person dialing the combination to see the numbers involved.

## ARM-A-DOR

SECURE PANIC HARDWARE



**A101 002**

## Panic Exit Bolt Hardware

Mfg #	Description	EZ #
A101 001	Standard Device	062836
A101 002	Device with Alarm	062837
A104 001	Low Profile Kit where Door Jamb's are Deeper than 6-3/4"	062840

- Conforms to these requirements and others: U.L. 305 Panic Device Rating, NFPA 101 Life Safety Code, ANSI 156.3,
- Arm-A-Dor® secure panic hardware offers 24 hour protection, keeping intruders out while providing life-saving security within.
- Offers locking bar protection for security from the outside, single motion egress, and Life Safety compliance.
- Designed as a security system for service and emergency exits, the Arm-A-Dor® device is for exit-only doors and cannot be configured to unlock from the outside.
- All models are Aluminum finish, exit-only for 3' to 4' doors, and can be mounted either left-hand or right-hand.
- Automatically locks whenever the door is closed.

## Anti-Surreptitious Combination Padlock



8077 108

Mfg #	EZ #
8077 108	027443

- Built to conform to stringent government specifications, including 30 minute protection against expert manipulation and 10 minute protection against surreptitious entry attack.
- Field changeable combination with the use of a change key.
- 125,000 possible combinations.
- Packaged with change key and complete operating/changing instructions.

### Dimensions and Specifications

- Size: 4-5/32"H x 2-3/8"W x 1-31/32"D
- Shackle material: Case hardened steel
- Shackle diameter: 5/16"
- Clear shackle opening when locked: 7/8"
- NSN #s: 5340-00-285-6523, 5340-01-217-2009, 5340-02-856-523

## Change Keys

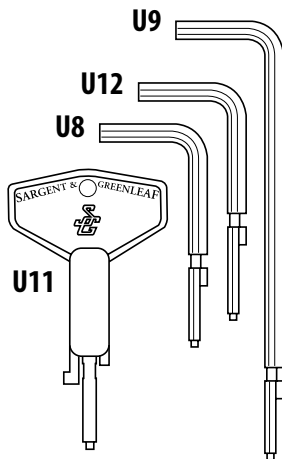

Mfg #	Type	EZ #
U8	3 Wheel for Standard Locks	029231
U11	6500 Vault Locks after 1956	037016
U12	4 Wheel for Standard Locks	037024
U9	Long Handle 3 Wheel for Standard Locks	039718

## Combination Lock Parts

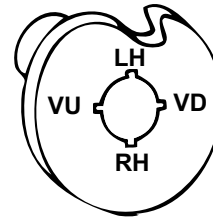

6720 005 512 000

- 4 Way drive cam for group 2 locks.

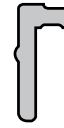

U17

- Spline Key For 6700 & 8500 Locks

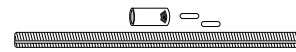

7312 003

- For standard locks. 5/16"-40 X 6" kit with .450" diameter collar.

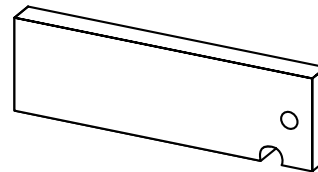

6730 003 140

- Extra long brass bolt extends 2.461" from end of lock case when locked, 2.109" from case when unlocked.

Mfg #	Description	EZ #
6720 005 512 000	4 Way Drive Cam	037022
U17	Spline Key For 6700 & 8500 Locks	037023
6730 003 140	Long Bolt for Group 2 Lock	037027
7312 003	5/16" Spindle Extension Kit	037030